

MAKINAK BAY - CRESTVIEW PARK DRIVE TO CRESTVIEW PARK DRIVE

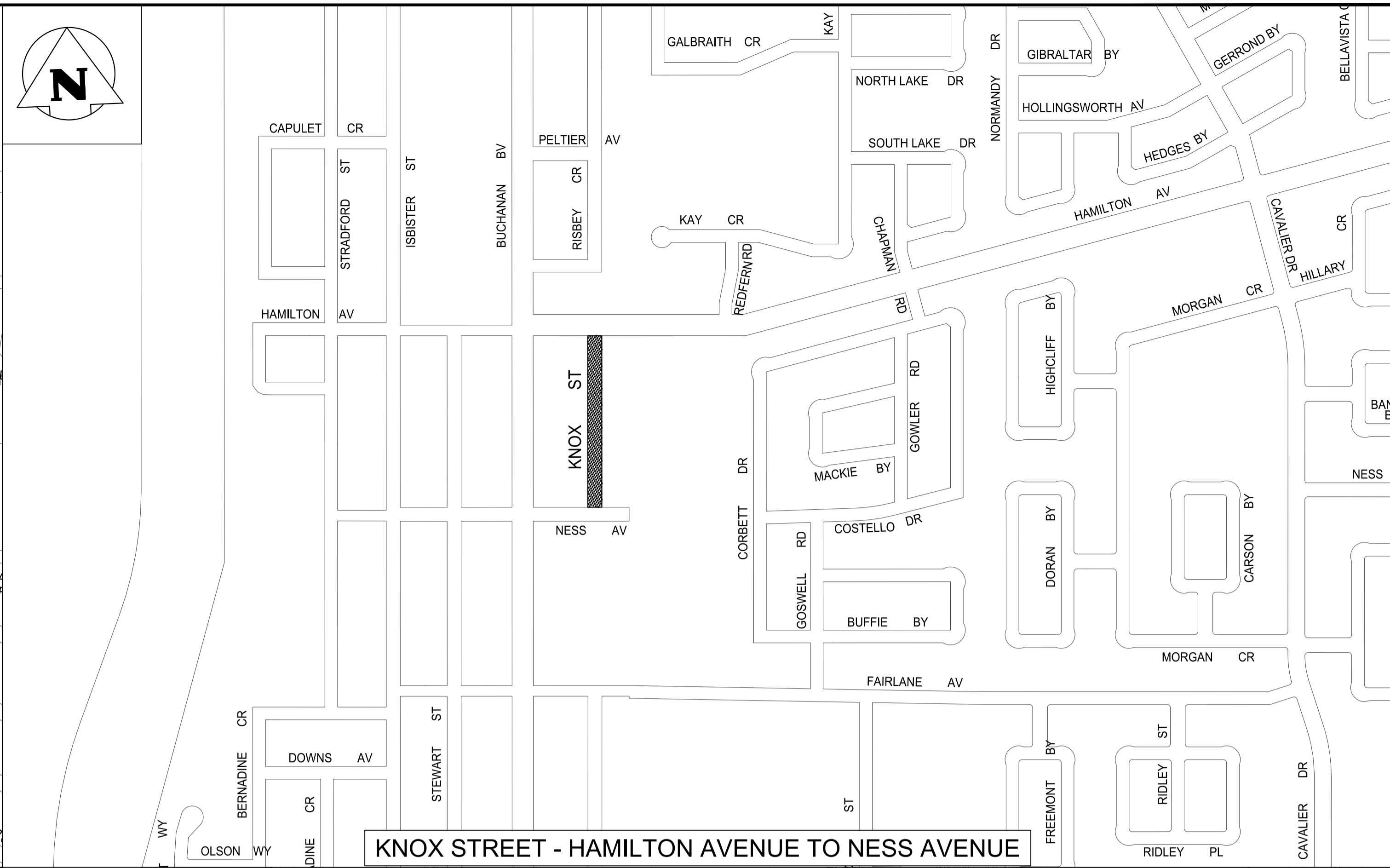

KNOX STREET - HAMILTON AVENUE TO NESS AVENUE

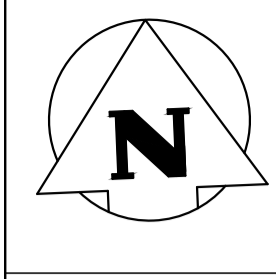

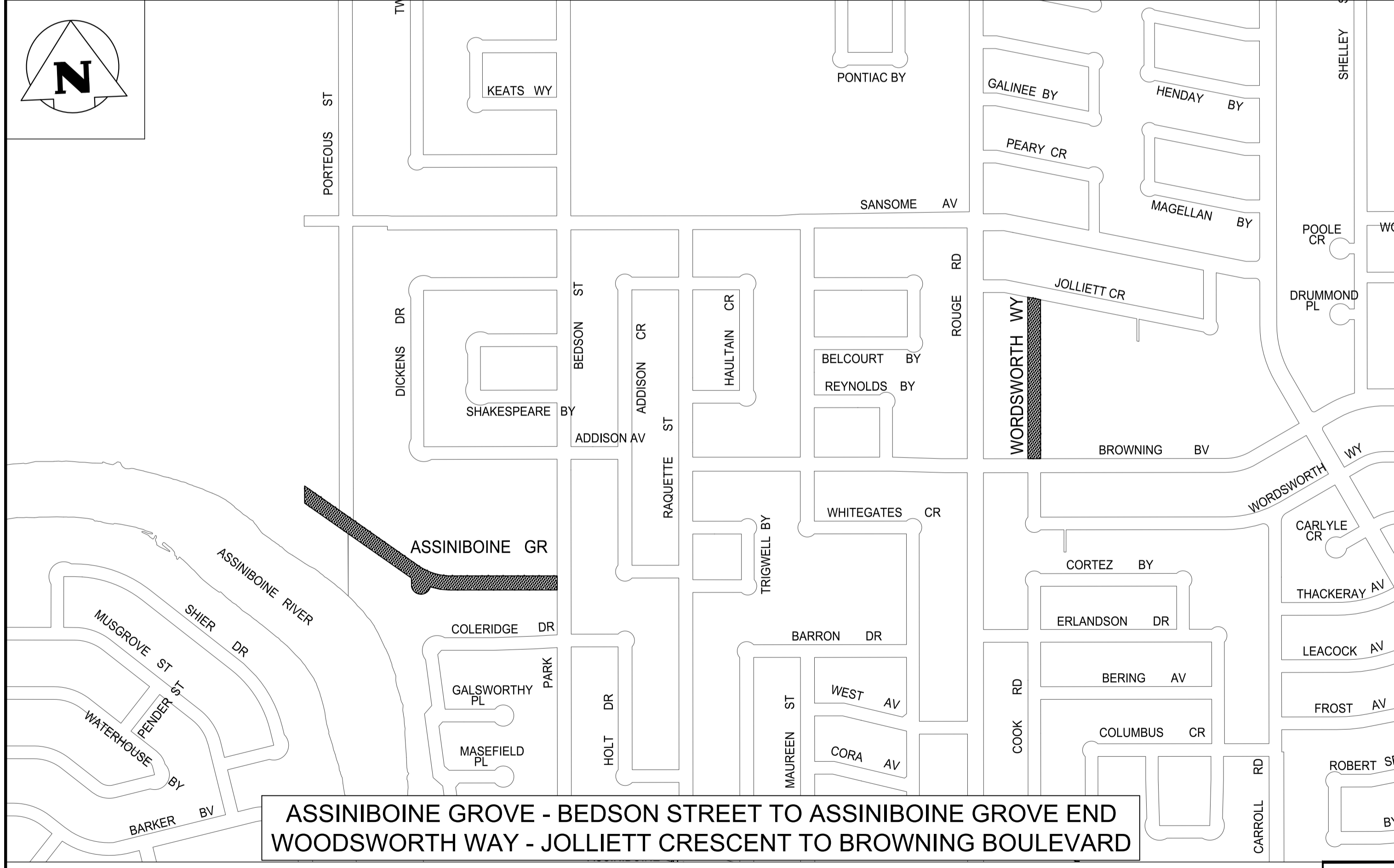

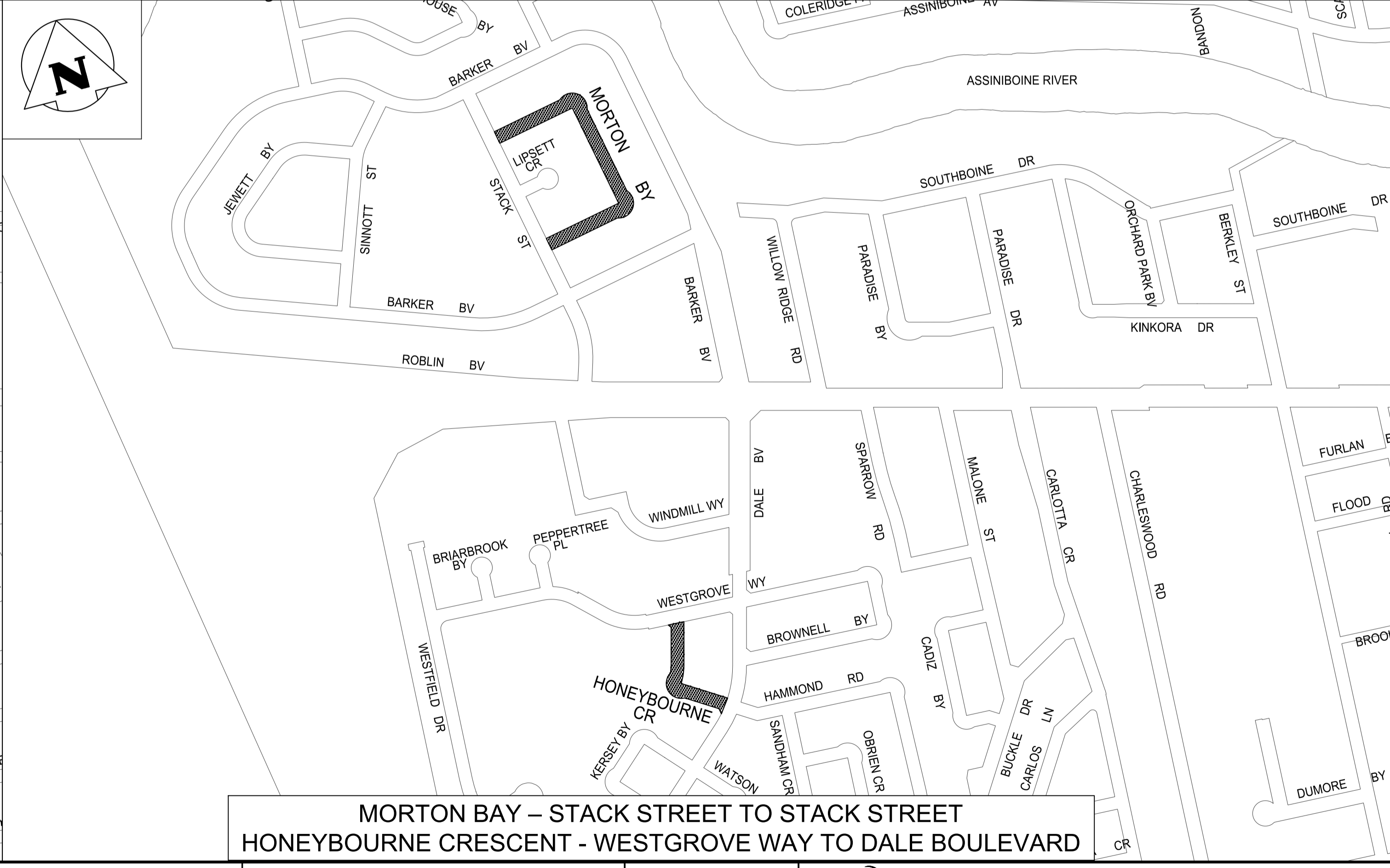
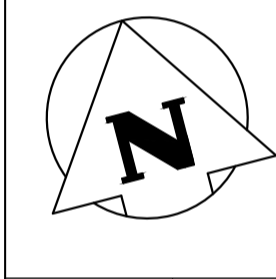
ASSINIBOINE GROVE - BEDSON STREET TO ASSINIBOINE GROVE END  
WOODSWORTH WAY - JOLLIETT CRESCENT TO BROWNING BOULEVARD



MORTON BAY - STACK STREET TO STACK STREET  
HONEYBOURNE CRESCENT - WESTGROVE WAY TO DALE BOULEVARD

\\k-file-41c-data\Projects\2022\22-0107-003\Drawings\Mun PLOT 1:1 (A-1)

LEGEND:

-  AREA OF NEW OVERLAY
-  BUS ROUTE
-  SCHOOL LOCATION



SCALE: 1:5000m (A1)

		<b>KGS GROUP</b>		DESIGNED BY	TT	CHECKED BY	-
				DRAWN BY	GEL	APPROVED BY	
		HOR. SCALE: 1:5000		RELEASED FOR CONSTRUCTION:			
NO. REVISIONS		DATE	BY	DATE	22/04/04	DATE	

**THE CITY OF WINNIPEG**  
PUBLIC WORKS DEPARTMENT  
ENGINEERING DIVISION

PROJECT TITLE  
**2022 THIN BITUMINOUS OVERLAY PROGRAM  
CONTRACT 1 - VARIOUS LOCATIONS**

MAKINAK BAY, KNOX STREET, ASSINIBOINE GROVE,  
WOODSWORTH WAY, MORTON BAY, HONEYBOURNE  
CRESCENT

CONSULTANT DRAWING NO.  
**C101**

SHEET	02	OF	04
COMPUTER FILE NAME	22-0107-003_C1.DWG		
CITY DRAWING NUMBER	-		